

CABLES DE ACERO

1. Cables de Acero.

DIN 3055

6 X 7 + 1

| | | | |
|-----------------------|---------------------------|------------------|--------|
| Composición: | 6x7+1 | Cordones: | 6 |
| Alma: | Textil | Hilos: | 42 |
| Superficie: | Galvanizada | Factor f: | 0.47 |
| Arrollamiento: | Cruzado derecha (sZ) | Factor k: | 0.9 |
| Resistencia: | 160 [kg/mm ²] | Factor w: | 0.9682 |



Tabla de cargas de rotura y densidades lineales:

| Ref. catálogo | Ø nominal (mm) | Tolerancia (%) | Peso aprox. (kg/m) | Carga de rotura calculada (kg) | Carga de rotura mínima (kg) |
|---------------|----------------|----------------|--------------------|--------------------------------|-----------------------------|
| 09010001 | 2 | +8/-0% | 0,0143 | 236 | 213 |
| 09010002 | 3 | +8/-0% | 0,0322 | 532 | 478 |
| 09010003 | 4 | +7/-0% | 0,0572 | 945 | 850 |
| 09010004 | 5 | +7/-0% | 0,0893 | 1.480 | 1.330 |
| 09010005 | 6 | +6/-0% | 0,129 | 2.130 | 1.910 |
| 09010006 | 7 | +6/-0% | 0,175 | 2.890 | 2.600 |
| 09010007 | 8 | +5/-0% | 0,229 | 3.780 | 3.400 |
| 09010008 | 9 | +5/-0% | 0,289 | 4.780 | 4.310 |
| 09010009 | 10 | +5/-0% | 0,357 | 5.910 | 5.320 |
| 09010010 | 11 | +5/-0% | 0,432 | 7.150 | 6.430 |
| 09010011 | 12 | +5/-0% | 0,515 | 8.500 | 7.650 |
| 09010012 | 13 | +5/-0% | 0,604 | 9.980 | 8.980 |
| 09010013 | 14 | +5/-0% | 0,701 | 11.600 | 10.400 |
| 09010014 | 16 | +5/-0% | 0,915 | 15.100 | 13.600 |
| 09010015 | 18 | +5/-0% | 1,16 | 19.100 | 17.200 |
| 09010016 | 20 | +5/-0% | 1,43 | 23.600 | 21.300 |
| 09010017 | 22 | +5/-0% | 1,73 | 28.600 | 25.700 |
| 09010018 | 24 | +5/-0% | 2,06 | 34.000 | 30.600 |
| 09010019 | 26 | +5/-0% | 2,42 | 39.900 | 35.900 |
| 09010020 | 28 | +5/-0% | 2,8 | 46.300 | 41.700 |
| 09010021 | 32 | +5/-0% | 3,66 | 60.500 | 54.400 |
| 09010022 | 36 | +5/-0% | 4,63 | 76.500 | 68.900 |
| 09010023 | 40 | +5/-0% | 5,72 | 94.500 | 85.000 |



DIN 3060

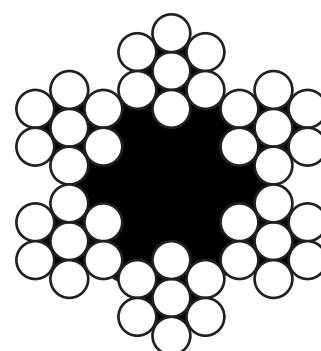
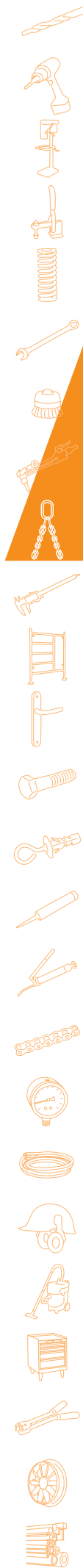
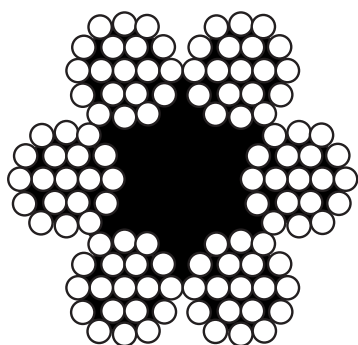

6 x 19 + 1

| | | | |
|-----------------------|---------------------------|------------------|--------|
| Composición: | 6x19+1 | Cordones: | 6 |
| Alma: | Textil | Hilos: | 114 |
| Superficie: | Galvanizada | Factor f: | 0.455 |
| Arrollamiento: | Cruzado derecha (sZ) | Factor k: | 0.86 |
| Resistencia: | 180 [kg/mm ²] | Factor w: | 0.9682 |

Tabla de cargas de rotura y densidades lineales:

| Ref. catálogo | Ø nominal (mm) | Tolerancia (%) | Peso aprox. (kg/m) | Carga de rotura calculada (kg) | Carga de rotura mínima (kg) |
|---------------|----------------|----------------|--------------------|--------------------------------|-----------------------------|
| 09010024 | 3 | +8/-0% | 0,0311 | 579 | 498 |
| 09010025 | 4 | +7/-0% | 0,0554 | 1.030 | 885 |
| 09010026 | 5 | +7/-0% | 0,0865 | 1.610 | 1.380 |
| 09010027 | 6 | +6/-0% | 0,125 | 2.320 | 1.990 |
| 09010028 | 7 | +6/-0% | 0,17 | 3.150 | 2.710 |
| 09010029 | 8 | +5/-0% | 0,221 | 4.120 | 3.540 |
| 09010030 | 9 | +5/-0% | 0,28 | 5.210 | 4.480 |
| 09010031 | 10 | +5/-0% | 0,346 | 6.430 | 5.530 |
| 09010032 | 11 | +5/-0% | 0,419 | 7.780 | 6.690 |
| 09010033 | 12 | +5/-0% | 0,498 | 9.260 | 7.970 |
| 09010034 | 13 | +5/-0% | 0,585 | 10.900 | 9.350 |
| 09010035 | 14 | +5/-0% | 0,678 | 12.600 | 10.800 |
| 09010036 | 16 | +5/-0% | 0,886 | 16.500 | 14.200 |
| 09010037 | 18 | +5/-0% | 1,12 | 20.800 | 17.900 |
| 09010038 | 20 | +5/-0% | 1,38 | 25.700 | 22.100 |
| 09010039 | 22 | +5/-0% | 1,67 | 31.100 | 26.800 |
| 09010040 | 24 | +5/-0% | 1,99 | 37.100 | 31.900 |
| 09010041 | 26 | +5/-0% | 2,34 | 43.500 | 37.400 |
| 09010042 | 28 | +5/-0% | 2,71 | 50.400 | 43.400 |
| 09010043 | 32 | +5/-0% | 3,54 | 65.900 | 56.600 |
| 09010044 | 36 | +5/-0% | 4,48 | 83.400 | 71.700 |
| 09010045 | 40 | +5/-0% | 5,54 | 103.000 | 88.500 |
| 09010046 | 44 | +5/-0% | 6,7 | 125.000 | 107.000 |
| 09010047 | 48 | +5/-0% | 7,97 | 148.000 | 127.000 |
| 09010048 | 52 | +5/-0% | 9,36 | 174.000 | 150.000 |
| 09010049 | 56 | +5/-0% | 10,9 | 202.000 | 173.000 |

2. Tensores.

Tensor Gancho / Gancho. DIN 1480

MODELO TGG

| Ref. catálogo | Código | Modelo | Medida | Carga trabajo S.W.L. (kg) | Medida Equival. | A | B | E | F |
|---------------|----------|---------|--------|---------------------------|-----------------|------|-----|-----|-----|
| 09010050 | 09520650 | TGG 105 | M 5 | 50 | 3/16" | 9 | 79 | 40 | 19 |
| 09010051 | 09520669 | TGG 106 | M 6 | 75 | 1/4" | 10 | 88 | 50 | 24 |
| 09010052 | 09520677 | TGG 108 | M 8 | 165 | 5/16" | 12 | 110 | 52 | 28 |
| 09010053 | 09520685 | TGG 110 | M 10 | 235 | 3/8" | 15 | 130 | 62 | 37 |
| 09010054 | 09520693 | TGG 111 | M 11 | 280 | 7/16" | 17,5 | 135 | 65 | 37 |
| 09010055 | 09520706 | TGG 112 | M 12 | 320 | 1/2" | 18 | 140 | 65 | 39 |
| 09010056 | 09520714 | TGG 114 | M 14 | 420 | 9/16" | 21 | 125 | 82 | 43 |
| 09010057 | 09520722 | TGG 116 | M 16 | 530 | 5/8" | 27 | 170 | 105 | 63 |
| 09010058 | 09520730 | TGG 120 | M 20 | 730 | 3/4" | 34 | 200 | 110 | 74 |
| 09010059 | 09520749 | TGG 122 | M 22 | 1120 | 7/8" | 36 | 220 | 125 | 80 |
| 09010060 | 09520757 | TGG 124 | M 24 | 1550 | 1" | 39 | 255 | 135 | 85 |
| 09010061 | 09520765 | TGG 127 | M 27 | 1870 | 1 1/16" | 45 | 255 | 135 | 86 |
| 09010062 | 09520773 | TGG 130 | M 30 | 2240 | 1 1/4" | 45 | 255 | 145 | 90 |
| 09010063 | 09520781 | TGG 132 | M 32 | 2850 | 1 5/16" | 45 | 255 | 145 | 92 |
| 09010064 | 09520790 | TGG 136 | M 36 | 3530 | 1 1/2" | 55 | 295 | 170 | 116 |

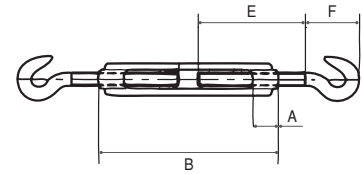

Tensor Anilla / Anilla. DIN 1480

MODELO TAA

| Ref. catálogo | Código | Modelo | Medida | Carga trabajo S.W.L. (kg) | Medida Equival. | A | B | D | C |
|---------------|----------|---------|--------|---------------------------|-----------------|------|-----|-----|-----|
| 09010065 | 09520853 | TAA 105 | M 5 | 140 | 3/16" | 9 | 79 | 40 | 19 |
| 09010066 | 09520861 | TAA 106 | M 6 | 225 | 1/4" | 10 | 88 | 50 | 24 |
| 09010067 | 09520870 | TAA 108 | M 8 | 410 | 5/16" | 12 | 110 | 52 | 28 |
| 09010068 | 09520888 | TAA 110 | M 10 | 650 | 3/8" | 15 | 130 | 60 | 37 |
| 09010069 | 09520896 | TAA 111 | M 11 | 790 | 7/16" | 17,5 | 135 | 65 | 37 |
| 09010070 | 09520909 | TAA 112 | M 12 | 930 | 1/2" | 18 | 140 | 67 | 39 |
| 09010071 | 09520917 | TAA 114 | M 14 | 1320 | 9/16" | 21 | 125 | 83 | 43 |
| 09010072 | 09520925 | TAA 116 | M 16 | 1770 | 5/8" | 27 | 170 | 97 | 63 |
| 09010073 | 09520933 | TAA 120 | M 20 | 2700 | 3/4" | 34 | 200 | 116 | 74 |
| 09010074 | 09520941 | TAA 122 | M 22 | 3300 | 7/8" | 36 | 220 | 120 | 80 |
| 09010075 | 09520950 | TAA 124 | M 24 | 3920 | 1" | 39 | 255 | 125 | 85 |
| 09010076 | 09520968 | TAA 127 | M 27 | 4950 | 1 1/16" | 45 | 255 | 150 | 86 |
| 09010077 | 09520976 | TAA 130 | M 30 | 6250 | 1 1/4" | 45 | 255 | 150 | 90 |
| 09010078 | 09520984 | TAA 133 | M 33 | 7560 | 1 5/16" | 45 | 255 | 150 | 92 |
| 09010079 | 09520992 | TAA 136 | M 36 | 9100 | 1 1/2" | 55 | 295 | 150 | 116 |

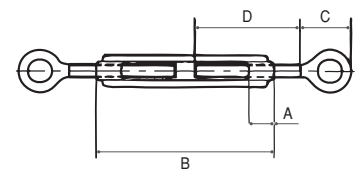

Tensor Gancho / Anilla. DIN 1480

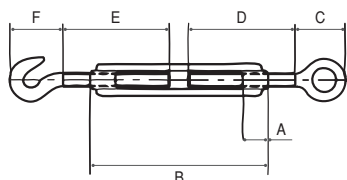

TGA

MODELO TGA

| Ref. catálogo | Código | Modelo | Medida | Carga trabajo S.W.L. (kg) | Medida Equival. | A | B | C | D | E | F |
|---------------|-----------|---------|--------|---------------------------|-----------------|----|-----|-----|-----|-----|-----|
| 09010080 | 09521100 | TGA 105 | M 5 | 50 | 3/16" | 9 | 79 | 19 | 40 | 40 | 19 |
| 09010081 | 09521119 | TGA 106 | M 6 | 75 | 1/4" | 10 | 88 | 24 | 50 | 50 | 24 |
| 09010082 | 09521127 | TGA 108 | M 8 | 165 | 5/16" | 12 | 110 | 28 | 52 | 52 | 28 |
| 09010083 | 09521135 | TGA 110 | M 10 | 235 | 3/8" | 15 | 130 | 37 | 60 | 62 | 37 |
| 09010084 | 09521143 | TGA 111 | M 11 | 280 | 7/16" | 17 | 135 | 37 | 65 | 65 | 37 |
| 09010085 | 09521151 | TGA 112 | M 12 | 320 | 1/2" | 18 | 140 | 39 | 67 | 65 | 39 |
| 09010086 | 09521160 | TGA 114 | M 14 | 420 | 9/16" | 21 | 155 | 43 | 83 | 82 | 43 |
| 09010087 | 09521178 | TGA 116 | M 16 | 530 | 5/8" | 27 | 170 | 63 | 97 | 105 | 63 |
| 09010088 | 09521186 | TGA 120 | M 20 | 730 | 3/4" | 34 | 200 | 74 | 116 | 110 | 74 |
| 09010089 | 09521194 | TGA 122 | M 22 | 1120 | 7/8" | 36 | 220 | 80 | 120 | 125 | 80 |
| 09010090 | 0952120-7 | TGA 124 | M 24 | 1550 | 1" | 39 | 255 | 85 | 125 | 135 | 85 |
| 09010091 | 09521215 | TGA 127 | M 27 | 1870 | 1 1/16" | 45 | 255 | 86 | 150 | 135 | 86 |
| 09010092 | 09521223 | TGA 130 | M 30 | 2240 | 1 1/4" | 45 | 255 | 90 | 150 | 145 | 90 |
| 09010093 | 09521231 | TGA 132 | M 32 | 2850 | 1 5/16" | 45 | 255 | 92 | 150 | 145 | 92 |
| 09010094 | 09521240 | TGA 136 | M 36 | 3530 | 1 1/2" | 55 | 295 | 116 | 150 | 170 | 116 |

Tensor Horquilla / Horquilla. DIN 1480

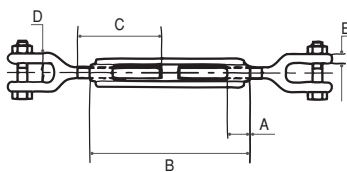

THH

MODELO THH

| Ref. catálogo | Código | Modelo | Medida | Carga trabajo S.W.L. (kg) | Medida Equival. | A | B | C | D | E |
|---------------|----------|---------|--------|---------------------------|-----------------|----|-----|-----|----|-----|
| 09010095 | 09521303 | THH 106 | M 6 | 230 | 3/16" | 10 | 88 | 60 | 8 | 4 |
| 09010096 | 09521311 | THH 108 | M 8 | 440 | 5/16" | 14 | 110 | 70 | 10 | 5 |
| 09010097 | 09521320 | THH 110 | M 10 | 440 | 3/8" | 15 | 130 | 80 | 12 | 6 |
| 09010098 | 09521338 | THH 112 | M 12 | 600 | 1/2" | 18 | 140 | 90 | 16 | 7 |
| 09010099 | 09521346 | THH 114 | M 14 | 600 | 9/16" | 20 | 170 | 95 | 18 | 7,5 |
| 09010100 | 09521354 | THH 116 | M 16 | 800 | 5/8" | 22 | 190 | 100 | 20 | 8 |
| 09010101 | 09521362 | THH 120 | M 20 | 1660 | 3/4" | 30 | 220 | 110 | 24 | 10 |
| 09010102 | 09521370 | THH 122 | M 22 | 2600 | 7/8" | 33 | 242 | 120 | 28 | 12 |
| 09010103 | 09521389 | THH 124 | M 24 | 2600 | 1" | 39 | 255 | 125 | 30 | 13 |
| 09010104 | 09521397 | THH 127 | M 27 | 2600 | 1 1/16" | 43 | 300 | 130 | 32 | 14 |
| 09010105 | 09521400 | THH 130 | M 30 | 3400 | 1 1/4" | 45 | 255 | 140 | 36 | 16 |
| 09010106 | 09521418 | THH 132 | M 32 | 4000 | 1 5/16" | 48 | 300 | 150 | 40 | 19 |
| 09010107 | 09521426 | THH 136 | M 36 | 4800 | 1 1/2" | 55 | 295 | 170 | 45 | 22 |

3. Bridas Sujetacables.

DIN 741

MODELO SCG

| Ref. catálogo | Código | Modelo | Medida | Ø cable mm | D | H | L | B | T |
|---------------|----------|---------|--------|------------|------|-----|-----|----|----|
| 09010108 | 09520010 | SCG 103 | 3 | 2-3 | M 4 | 20 | 21 | 12 | 10 |
| 09010109 | 09520028 | SCG 105 | 5 | 4-5 | M 5 | 24 | 24 | 13 | 11 |
| 09010110 | 09520036 | SCG 106 | 6 | 6.5 | M 5 | 28 | 26 | 15 | 12 |
| 09010111 | 09520044 | SCG 108 | 8 | 8 | M 6 | 34 | 30 | 19 | 14 |
| 09010112 | 09520052 | SCG 110 | 10 | 10 | M 8 | 42 | 27 | 22 | 20 |
| 09010113 | 09520060 | SCG 111 | 11 | 11 | M 8 | 44 | 38 | 22 | 20 |
| 09010114 | 09520079 | SCG 113 | 13 | 13 | M 10 | 55 | 44 | 30 | 25 |
| 09010115 | 09520087 | SCG 114 | 14 | 14 | M 10 | 55 | 46 | 30 | 27 |
| 09010116 | 09520095 | SCG 116 | 16 | 16 | M 10 | 63 | 53 | 32 | 31 |
| 09010117 | 09520108 | SCG 119 | 19 | 18 | M 12 | 78 | 59 | 38 | 33 |
| 09010118 | 09520124 | SCG 122 | 22 | 22 | M 12 | 81 | 64 | 45 | 34 |
| 09010119 | 09525697 | SCG 126 | 26 | 26 | M 12 | 96 | 75 | 50 | 42 |
| 09010120 | 09525700 | SCG 130 | 30 | 30 | M 14 | 112 | 86 | 58 | 44 |
| 09010121 | 09525865 | SCG 134 | 34 | 34 | M 16 | 120 | 93 | 61 | 48 |
| 09010122 | 09520167 | SCG 140 | 40 | 36-38 | M 16 | 130 | 95 | 63 | 51 |
| 09010123 | 09520175 | SCG 145 | 45 | 45 | M 16 | 158 | 115 | 83 | 58 |
| 09010124 | 09520183 | SCG 150 | 50 | 50 | M 16 | 158 | 115 | 83 | 59 |

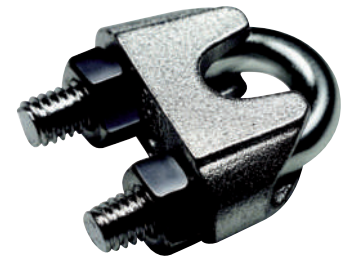
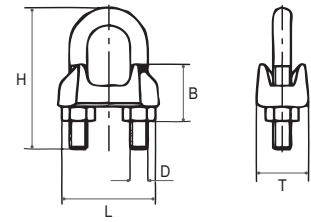

SCG

4. Cáncamos.

Anilla de Elevación. DIN 582

MACHO. MODELO AEM

| Ref. catálogo | Código | Modelo | Medida | Carga trabajo S.W.L. (kg) | D1 | D2 | D3 | L |
|---------------|----------|---------|--------|---------------------------|----|-----|----|----|
| 09010125 | 09522613 | AEM 106 | M 6 | 90 | 6 | 36 | 20 | 13 |
| 09010126 | 09522621 | AEM 108 | M 8 | 140 | 8 | 36 | 20 | 13 |
| 09010127 | 09522630 | AEM 110 | M 10 | 230 | 10 | 45 | 25 | 17 |
| 09010128 | 09522648 | AEM 112 | M 12 | 340 | 12 | 54 | 30 | 20 |
| 09010129 | 09522656 | AEM 114 | M 14 | 500 | 14 | 54 | 30 | 20 |
| 09010130 | 09522664 | AEM 116 | M 16 | 700 | 16 | 63 | 35 | 27 |
| 09010131 | 09522672 | AEM 118 | M 18 | 930 | 18 | 63 | 35 | 27 |
| 09010132 | 09522680 | AEM 120 | M 20 | 1200 | 20 | 72 | 40 | 30 |
| 09010133 | 09522699 | AEM 122 | M 22 | 1500 | 22 | 72 | 40 | 30 |
| 09010134 | 09522701 | AEM 124 | M 24 | 1800 | 24 | 90 | 50 | 36 |
| 09010135 | 09522710 | AEM 127 | M 27 | 2500 | 27 | 98 | 54 | 40 |
| 09010136 | 09522728 | AEM 130 | M 30 | 3600 | 30 | 108 | 60 | 45 |
| 09010137 | 09522736 | AEM 133 | M 33 | 4200 | 33 | 108 | 60 | 45 |
| 09010138 | 09522744 | AEM 136 | M 36 | 5100 | 36 | 126 | 70 | 54 |
| 09010139 | 09522752 | AEM 142 | M 42 | 7000 | 42 | 144 | 80 | 63 |
| 09010140 | 09522760 | AEM 148 | M 48 | 8600 | 48 | 160 | 90 | 68 |

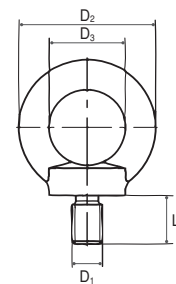

AEM

09/ ELEVACIÓN Y TRANSPORTE

CABLES DE ACERO / GATOS

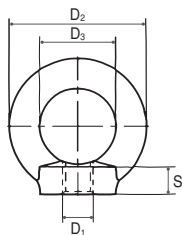

AEH

HEMBRA. MODELO AEH

| Ref. catálogo | Código | Modelo | Medida | Carga trabajo S.W.L. (kg) | D1 | D2 | D3 | S |
|---------------|----------|---------|--------|---------------------------|----|-----|----|-----|
| 09010141 | 09522816 | AEH 106 | M 6 | 90 | 6 | 36 | 20 | 8,5 |
| 09010142 | 09522824 | AEH 108 | M 8 | 140 | 8 | 36 | 20 | 8,5 |
| 09010143 | 09522832 | AEH 110 | M 10 | 230 | 10 | 45 | 25 | 10 |
| 09010144 | 09522840 | AEH 112 | M 12 | 340 | 12 | 54 | 30 | 11 |
| 09010145 | 09522859 | AEH 114 | M 14 | 500 | 14 | 54 | 30 | 11 |
| 09010146 | 09522867 | AEH 116 | M 16 | 700 | 16 | 63 | 35 | 13 |
| 09010147 | 09522875 | AEH 118 | M 18 | 930 | 18 | 63 | 35 | 13 |
| 09010148 | 09522883 | AEH 120 | M 20 | 1200 | 20 | 72 | 40 | 16 |
| 09010149 | 09522891 | AEH 122 | M 22 | 1500 | 22 | 72 | 40 | 16 |
| 09010150 | 09522904 | AEH 124 | M 24 | 1800 | 24 | 90 | 50 | 20 |
| 09010151 | 09522912 | AEH 127 | M 27 | 2500 | 27 | 98 | 54 | 20 |
| 09010152 | 09522920 | AEH 130 | M 30 | 3600 | 30 | 108 | 60 | 25 |
| 09010153 | 09522939 | AEH 136 | M 36 | 5100 | 36 | 126 | 70 | 30 |
| 09010154 | 09522947 | AEH 142 | M 42 | 7000 | 42 | 144 | 80 | 35 |
| 09010155 | 09522955 | AEH 148 | M 48 | 8600 | 48 | 160 | 90 | 40 |

5. Grilletes.

Grilletes Rectos

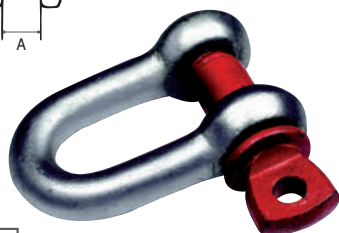
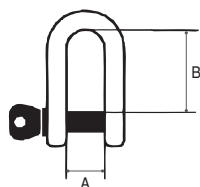

GRAR

ALTA RESISTENCIA

| Ref. catálogo | Código | Modelo | Medida | Carga trabajo S.W.L. (kg) | A | B |
|---------------|----------|----------|--------|---------------------------|----|----|
| 09010156 | 09527908 | GRAR 105 | 5 | 330 | 10 | 19 |
| 09010157 | 09527916 | GRAR 106 | 6 | 500 | 13 | 24 |
| 09010158 | 09527924 | GRAR 108 | 8 | 750 | 16 | 30 |
| 09010159 | 09527932 | GRAR 110 | 10 | 1000 | 19 | 40 |
| 09010160 | 09527959 | GRAR 112 | 12 | 2000 | 23 | 48 |
| 09010161 | 09527975 | GRAR 116 | 16 | 3000 | 32 | 64 |
| 09010162 | 09527991 | GRAR 120 | 20 | 4750 | 38 | 72 |
| 09010163 | 09528003 | GRAR 122 | 22 | 6500 | 44 | 83 |

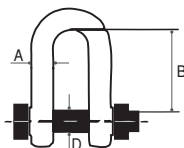

GRART

ALTA RESISTENCIA. CON TUERCA

| Ref. catálogo | Código | Modelo | Medida | Carga trabajo S.W.L. (kg) | D | A | B |
|---------------|----------|-----------|--------|---------------------------|----|----|----|
| 09010164 | 09528134 | GRART 105 | 5 | 330 | 7 | 6 | 23 |
| 09010165 | 09528142 | GRART 106 | 6 | 500 | 8 | 7 | 25 |
| 09010166 | 09528150 | GRART 108 | 8 | 750 | 10 | 9 | 27 |
| 09010167 | 09528169 | GRART 110 | 10 | 1000 | 11 | 10 | 31 |
| 09010168 | 09528177 | GRART 112 | 12 | 2000 | 16 | 14 | 43 |
| 09010169 | 90528185 | GRART 116 | 16 | 3250 | 19 | 16 | 51 |
| 09010170 | 09528193 | GRART 120 | 20 | 4750 | 22 | 19 | 59 |

Grilletes Lira

ALTA RESISTENCIA

| Ref. catálogo | Código | Modelo | Medida | Carga trabajo S.W.L. (kg) | A | B | C |
|---------------|----------|----------|--------|---------------------------|----|----|----|
| 09010171 | 09528206 | GLAR 105 | 5 | 330 | 10 | 16 | 20 |
| 09010172 | 09528214 | GLAR 106 | 6 | 500 | 13 | 20 | 24 |
| 09010173 | 09528222 | GLAR 108 | 8 | 750 | 16 | 24 | 32 |
| 09010174 | 09528230 | GLAR 110 | 10 | 1000 | 19 | 32 | 43 |
| 09010175 | 09528249 | GLAR 111 | 11 | 1500 | 22 | 35 | 44 |
| 09010176 | 09528257 | GLAR 112 | 12 | 2000 | 25 | 38 | 48 |
| 09010177 | 09528265 | GLAR 114 | 14 | 2500 | 28 | 44 | 62 |
| 09010178 | 09528273 | GLAR 116 | 16 | 3250 | 32 | 50 | 64 |
| 09010179 | 09528281 | GLAR 120 | 20 | 4750 | 38 | 66 | 80 |
| 09010180 | 09528290 | GLAR 122 | 22 | 6500 | 44 | 74 | 90 |

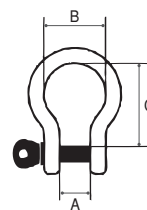

GLAR



ALTA RESISTENCIA. CON TUERCA

| Ref. catálogo | Código | Modelo | Medida | Carga trabajo S.W.L. (kg) | A | B | C | D |
|---------------|----------|-----------|--------|---------------------------|----|----|----|----|
| 09010181 | 09528337 | GLART 105 | 5 | 330 | 10 | 18 | 23 | 7 |
| 09010182 | 09528345 | GLART 106 | 6 | 500 | 12 | 20 | 25 | 8 |
| 09010183 | 09528353 | GLART 108 | 8 | 750 | 14 | 21 | 27 | 10 |
| 09010184 | 09528361 | GLART 110 | 10 | 1000 | 17 | 26 | 31 | 11 |
| 09010185 | 09528370 | GLART 112 | 12 | 2000 | 22 | 32 | 43 | 16 |
| 09010186 | 09528388 | GLART 116 | 16 | 3250 | 27 | 43 | 51 | 19 |
| 09010187 | 09528396 | GLART 120 | 20 | 4750 | 31 | 51 | 59 | 22 |

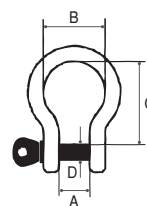

GLART



GATOS

1. Gatos de Botella.

De Botella

| Ref. catálogo | Código | Capacidad (t) | Altura mínima (mm) | Carrera hidráulica (mm) | Recorrido husillo (mm) | Peso (kg) |
|---------------|--------|---------------|--------------------|-------------------------|------------------------|-----------|
| 09050001 | MG-2 | 2 | 160 | 100 | 50 | 3,6 |
| 09050002 | MG-3 | 3 | 168 | 105 | 65 | 3,9 |
| 09050003 | MG-3A | 3 | 210 | 150 | 65 | 4,2 |
| 09050004 | MG-5 | 5 | 212 | 150 | 75 | 5,0 |
| 09050005 | MG-8 | 8 | 219 | 150 | 75 | 5,9 |
| 09050006 | MG-10 | 10 | 219 | 150 | 75 | 6,5 |
| 09050007 | MG-12 | 12 | 226 | 150 | 75 | 8,0 |
| 09050008 | MG-15 | 15 | 228 | 150 | 75 | 9,0 |
| 09050009 | MG-20 | 20 | 234 | 150 | 75 | 12,1 |
| 09050010 | MG-25 | 25 | 240 | 150 | 75 | 15,0 |
| 09050011 | MG-30 | 30 | 242 | 150 | 75 | 15,5 |
| 09050012 | MG-40 | 40 | 246 | 150 | - | 23,5 |
| 09050013 | MG-50 | 50 | 252 | 150 | - | 28,5 |



Telescópicos

| Ref. catálogo | Código | Capacidad (t) | Altura mínima (mm) | Carrera hidráulica (mm) | Recorrido husillo (mm) |
|---------------|---------|---------------|--------------------|-------------------------|------------------------|
| 09050014 | MGT-2 | 2 | 145 | 165 | 50 |
| 09050015 | MGT-2MI | 2 | 145 | 165 | 50 |
| 09050016 | MGT-5 | 5 | 215 | 300 | - |
| 09050017 | MGT-8 | 8 | 235 | 316 | - |
| 09050018 | MGT-12 | 12 | 245 | 326 | - |
| 09050019 | MGT-20 | 20 | 180 | 205 | - |